

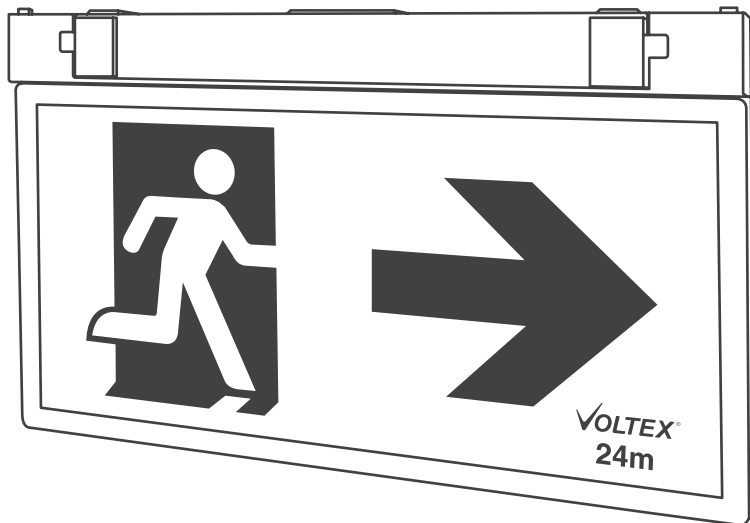

# LED EMERGENCY EXIT LIGHTS INSTALLATION AND OPERATING INSTRUCTIONS

EXL



BUSINESS NAME:

---

CONTACT:

---

INSTALLATION DATE:





## SPECIFICATIONS

Part No.	EXL
Input Voltage	220-240VAC 50/60Hz
Charge Time	16H
Battery Type	LiFePO4 3.2V 600mAh
Color Temperature	CCT 6000K
Emergency Duration	2 Hours
Power Consumption	Max 3W
Luminaires Class	Class II
Mode	Maintained
IP Rating	IP20
Mounting Type	Ceiling or Wall Mount
Ambient Operating Temperature	0°C~45°C
Test Mode	Manual

## PRECAUTIONS

**Normal Operation:** The green LED indicator stays on when connected to mains supply. The indicator will turn off when the mains supply fails, or when the internal charger malfunctions, or when the luminaire is in test mode.

**Battery:** LiFePO4 rechargeable battery pack. Battery should be replaced when it reaches the end of its lifetime. To avoid damage to the luminaire and ensure its performance, the battery should be replaced with same type.

**Test Switch:** Press the test button, LED indicator will turn off and the luminaire will be powered by the battery pack. The light source is non-replaceable. When the light source reaches the end of its lifetime, the whole luminaire shall be replaced.

## DIMENSIONS

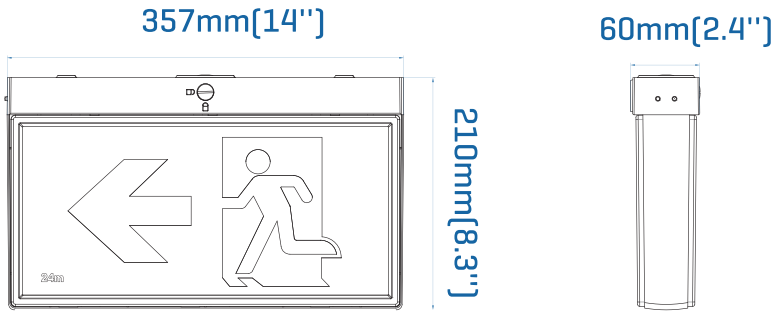

## PICTOGRAM



## WARNINGS

1. Switch off main supply before installation or maintenance.
2. Switch on only after complete installation and examination of the circuit.
3. Professional electrician for installation and maintenance only.
4. This luminaire is not intended for use in high-risk task area lighting.

## CEILING MOUNTING

1. To remove the cover, release the clip by turning cover screw to the left.

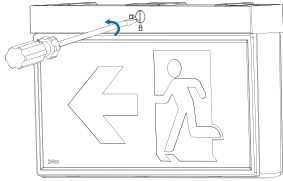

2. The top cover can then be removed by sliding it away.

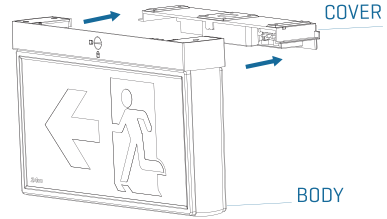

3. Mount the cover and connect 240VAC to the correct terminals.

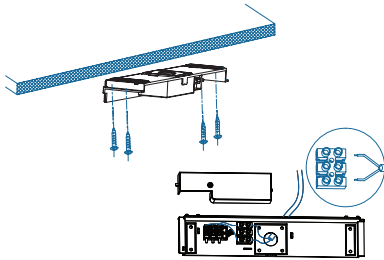

4. Connect the battery by plugging in the connector.

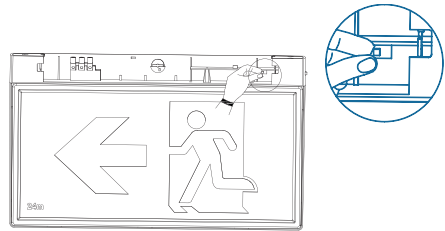

5. Connect the Exit light by sliding it into the base and engaging the terminal.

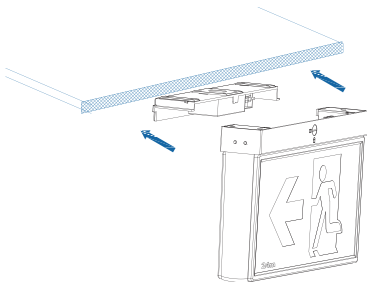

6. Then lock the Exit light in place by turning the clip to the right.

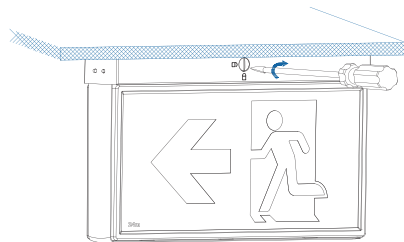

# WALL MOUNTING

1. To remove the cover, release the clip by turning cover screw to the left.

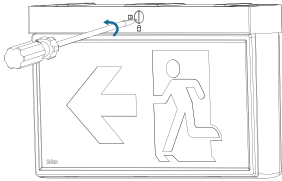

2. The top cover can then be removed by sliding it away.

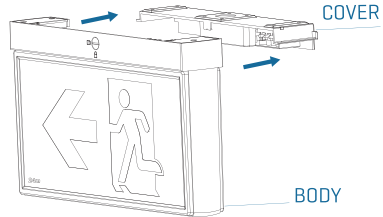

3. Knock/drill out the mounting holes and AC wiring hole in the cover. Then mount to the wall and connect 240VAC to the correct terminals.

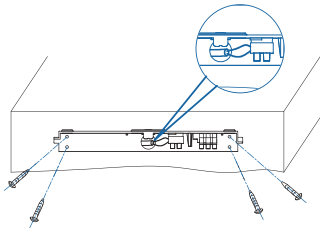

4. Connect the battery by plugging in the connector.

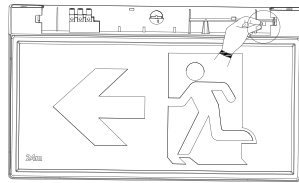

5. Connect the Exit light by sliding it into the base and engaging the terminal.

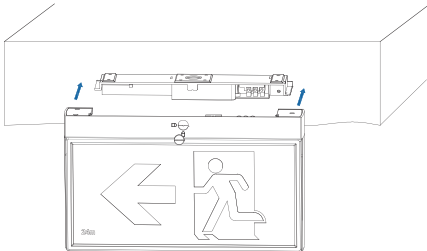

6. Then lock the Exit light in place by turning the clip to the right.

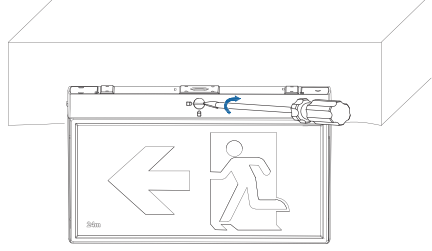

## BATTERY REPLACEMENT

Step 1: Turn the exit light off, and open the housing by pressing on indicated sections to unclip the housing.

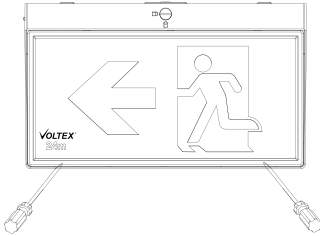

Step 2: Disconnect the battery and remove it from the clips

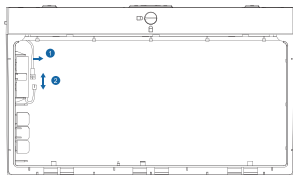

Step 3: Connect the new battery, and clip it into place, and fit housing into place by pressing the front of housing to engage 3 front clips.

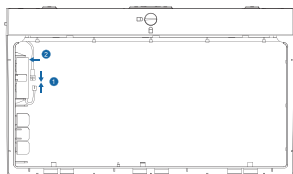

# INSTRUCTIONS FOR AUTOMATIC TEST OPTION

## 1. Instruction for Automatic test function

- Once the unit is powered up, a self diagnostic test will be automatically initiated and run every second
- Check battery, lamp and charge board
- Runs a 2H duration test every six months

Note: All test functions are preset and cannot be adjusted

## 2. Dual Colour LED Status Indicator

- Green indicator on: Ready/ Normal Operation
- Yellow indicator flashes: Require service

Fast Yellow Flash: 0.5s ON and 0.5s OFF	Errors
Slow Yellow Flash: 1s ON and 1s OFF	Under Test
Slow Yellow Flash: 4s ON and 1s OFF [The indication remains for 5 days and reverts to normal Green]	Work Normally

## 3. Manual Test/Button Test

Press test button once with 0.2s to 1s	Run a 5s duration test
Press test button twice within 2 seconds	Run a 3 minute duration test
Press test button 3 times within 2 seconds	Run a 30 minutes duration test
Press test button 4 times within 2 seconds	Run a 2 hours duration test
Press test button more than 2s	Clean Errors

### Manual Test Interruption

Pressing the button once during emergency discharge cancels the process, switching the green indicator to steady illumination.

*Note: When the fault is restored, press the test button for 2s, the yellow flashing indicator will turn green. The fault is cleared, and the unit is back to normal.*



# IP20



Voltex warrants its Emergency Lighting against defective workmanship and faulty materials for 3 years from the original date of purchase. Please retain proof of purchase and certificate of electrical compliance.

Contact Voltex Electrical on 1300 722 275 [Australia]  
or 0800 55 66 33 [New Zealand] for any warranty claims.

**VOLTEX**<sup>®</sup>

© Voltex Electrical 2024. All Rights Reserved.

AU P: 1300 722 275  
E: [sales@voltex.com](mailto:sales@voltex.com)  
[www.voltex.com](http://www.voltex.com)

NZ P: 0800 55 66 33  
E: [sales@voltex.com](mailto:sales@voltex.com)  
[www.voltex.com](http://www.voltex.com)